

1. EXISTING TWIN
CULVERTS 11'x11'
2. EXISTING STONE ARCH BRIDGE
3. NEW CULVERTS (4) 9'x8'
4. WATER STREET
5. DAYLIGHTING / MARGIN ZONE
6. 100 YEAR FLOOD
7. BROWNFIELD

#001

Posted by **Tim Rosenbury** on **04/02/2021** at **9:28am** [Comment ID: 5340] - [Link](#)

Type: Idea

Agree: 1, Disagree: 0

MSU is a really important site factor. With 2000 people there every weekday, they offer the best potential to populate the space when it's not programmed. The spatial relationship between the IDEA Commons (and Brick City in particular) can't be overemphasized.

Reply by **Branden Schwab** on **04/02/2021** at **12:55pm** [Comment ID: 5365] - [Link](#)

Type: Question

Agree: 0, Disagree: 0

Strongly agree! With students & faculty using these existing parking areas we see daily migrations across Mill St. to these spaces. (hence "Look" signage", see <https://art.missouristate.edu/>).

Skateboarders & cyclists also sometimes congregate in these lots, how can the space serve these existing informal recreational users?

#002

Posted by **Tim Rosenbury** on **04/02/2021** at **9:30am** [Comment ID: 5341] - [Link](#)

Type: Question

Agree: 1, Disagree: 0

How might this site connect to the West Meadows, and the West Meadows greenway? What might that mean for the site plan within the project?

#003

Posted by **John McQueary** on **04/02/2021** at **3:49pm** [Comment ID: 5393] - [Link](#)

Agree: 0, Disagree: 0

Having a pedestrian walkway under Campbell is absolutely key. Otherwise the spaces would feel quite isolated.

Saving and embracing the old arch would be fantastic.

#004

Posted by **Branden Schwab** on **04/02/2021** at **12:48pm** [Comment ID: 5363] - [Link](#)

Type: Idea

Agree: 0, Disagree: 0

Mature trees & rocky bluffs here, consider how this green/natural backdrop can frame use of the space. I've done a lot of clean up in this space in the past... consider how proximity of meandering path might encourage or discourage undesired use. <https://www.google.com/maps/@37.2108838,-93.2942299,3a,60y,226.37h,87.59t/data=!3m6!1e1!3m4!1se9wRrETrH5KeSLVZuuRt1Q!2e0!7i16384!8i8192>

#005

Posted by **Branden Schwab** on **04/02/2021** at **12:21pm** [Comment ID: 5356] - [Link](#)

Type: Question

Agree: 0, Disagree: 0

Beautiful poppy/bold linework & color! Is this all hand drawn & scanned? Or done via tablet & stylus? Reads much clearer than some other's. Well done!

Reply by **Branden Schwab** on **04/02/2021** at **12:40pm** [Comment ID: 5362] - [Link](#)

Type: Typo

Agree: 0, Disagree: 0

update: I realize now this is purely a site analysis and not a presentation of idea/concept... still I prefer this rendering technique for it's clarity, simplicity!

#006

Posted by **Branden Schwab** on **04/02/2021** at **12:49pm** [Comment ID: 5364] - [Link](#)

Type: *Typo*

Agree: 0, Disagree: 0

"7"? Brownfield?

#007

Posted by **Branden Schwab** on **04/02/2021** at **1:00pm** [Comment ID: 5366] - [Link](#)

Type: *Idea*

Agree: 0, Disagree: 0

MSU annex/storage building filled w/ old file cabinets, desk, equipment, appliances.... lots of stuff to move? Or use somehow in the interim? Think outdoor shared office space under broad pavilion, similar to Matthew Mazzota's (Cloud House @ Farmer's Park & others) outdoor living rooms for engaging public discussions about public artwork. <https://www.matthewmazzotta.com/home#content>

Reply by **Branden Schwab** on **04/02/2021** at **1:02pm** [Comment ID: 5367] - [Link](#)

Agree: 0, Disagree: 0

open air co-working? Ride in on bike or skateboard w/ lop top and connect to wifi for outdoor working? see CAST co-working space at Farmer's Park & formerly the Creative Foundry (now Arkifex)

#008

Posted by **Mary Kromrey** on **04/05/2021** at **11:01am** [Comment ID: 5441] - [Link](#)

Type: *Idea*

Agree: 0, Disagree: 0

The Jordan Creek Greenway trail will provide the movement and connectivity between the various hubs within the Jordan Valley Master Plan. Now would be a great time to figure out how to connect to the Jordan Creek Greenway trail in West Meadows and at Jefferson Avenue. Also, some concepts of Grant Avenue Parkway indicated it may include Mill Street. I think it would be beneficial to show all of the connectivity that promotes walkability.

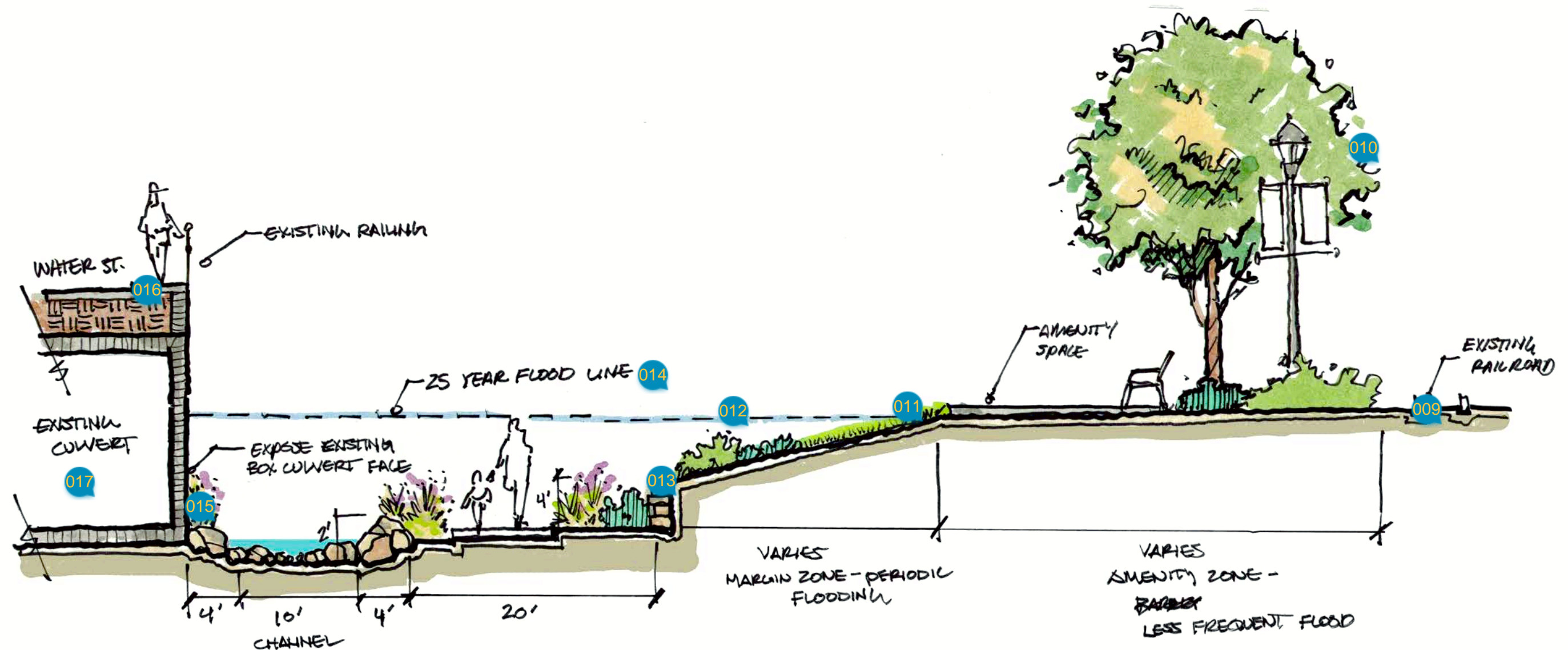

#009

Posted by **Branden Schwab** on **04/02/2021** at **12:38pm** [Comment ID: 5361] - [Link](#)

Type: Idea

Agree: 0, Disagree: 0

see Eldorado's Prairie Logic (<https://www.archdaily.com/557816/prairie-logic-el-dorado>).

If not able to place a box car stage element on an active rail line, consider adding to the terminated rail "beneath" (north of) Olive Street Apts. & Artifact. (see also BBSGF Dog Park concept, refer to Plan comment)

#010

Posted by **Tim Rosenbury** on **04/02/2021** at **9:31am** [Comment ID: 5342] - [Link](#)

Type: Idea

Agree: 0, Disagree: 0

Old-timey lights -- is that what we're going for in the 21st century?

#011

Posted by **Ryan Mooney** on **04/02/2021** at **4:18pm** [Comment ID: 5402] - [Link](#)

Type: Answer

Agree: 0, Disagree: 0

I like these "elevation" or "cross section" look at the project. It really helps explain how it might look and give the perspective needed to understand the floodplain, the existing box, etc.

#012

Posted by **Branden Schwab** on **04/02/2021** at **12:26pm** [Comment ID: 5357] - [Link](#)

Type: Idea

Agree: 0, Disagree: 0

Really appreciate seeing this in section! Wish other ideas were also shown in section. As this is west facing, consider including sunset, viaduct & graffiti towers in the distance at low opacity. See Renzo Piano's 1 point perspectives & sections w/ gradients to borrow rendering techniques...
<https://www.archdaily.com/875209/centro-botin-renzo-piano-building-workshop/595d1797b22e38537c00000c-centro-botin-renzo-piano-building-workshop-transversal-section>

#013

Posted by **Branden Schwab** on **04/02/2021** at **12:29pm** [Comment ID: 5358] - [Link](#)

Type: Idea

Agree: 0, Disagree: 0

consider showing how pedestrians engage low wall w/ seating elements & entourage, especially dogs that love to hop up on these low walls! Avoid drop hazard w/ plant buffer as shown (well done!)...boxwoods? hedges? roses?

#014

Posted by **Tim Rosenbury** on **04/02/2021** at **9:24am** [Comment ID: 5339] - [Link](#)

Type: Question

Agree: 1, Disagree: 0

Where would the 100-year flood line be? How do the plans for the Meeks site and the upstream regional detention basin plans impact this line (and the 25-year line)?

#015

Posted by **Branden Schwab** on **04/02/2021** at **12:31pm** [Comment ID: 5360] - [Link](#)

Type: Question

Agree: 0, Disagree: 0

how well do these grasses grow in full shade?

#016

Posted by **Branden Schwab** on **04/02/2021** at **12:31pm** [Comment ID: 5359] - [Link](#)

Type: Question

Agree: 0, Disagree: 0

this walkway is wider, no? More like 7', room for two pairs of pedestrians to pass? Show at scale to emphasize existing walkability of this overlook path.

#017

Posted by **Tim Rosenbury** on **04/02/2021** at **9:32am** [Comment ID: 5343] - [Link](#)

Agree: 0, Disagree: 0

I've asked the contractor to look at what it cost to remove this and to let us know.

IDEA ONE

West Side - Big Development

- Mixed-use development
- Below grade or first floor parking
- Remove box culvert
- Native trails / meadows

East Side - Big Scoop

- Broad big excavation
- Creates most stormwater storage
- People space / use below street level

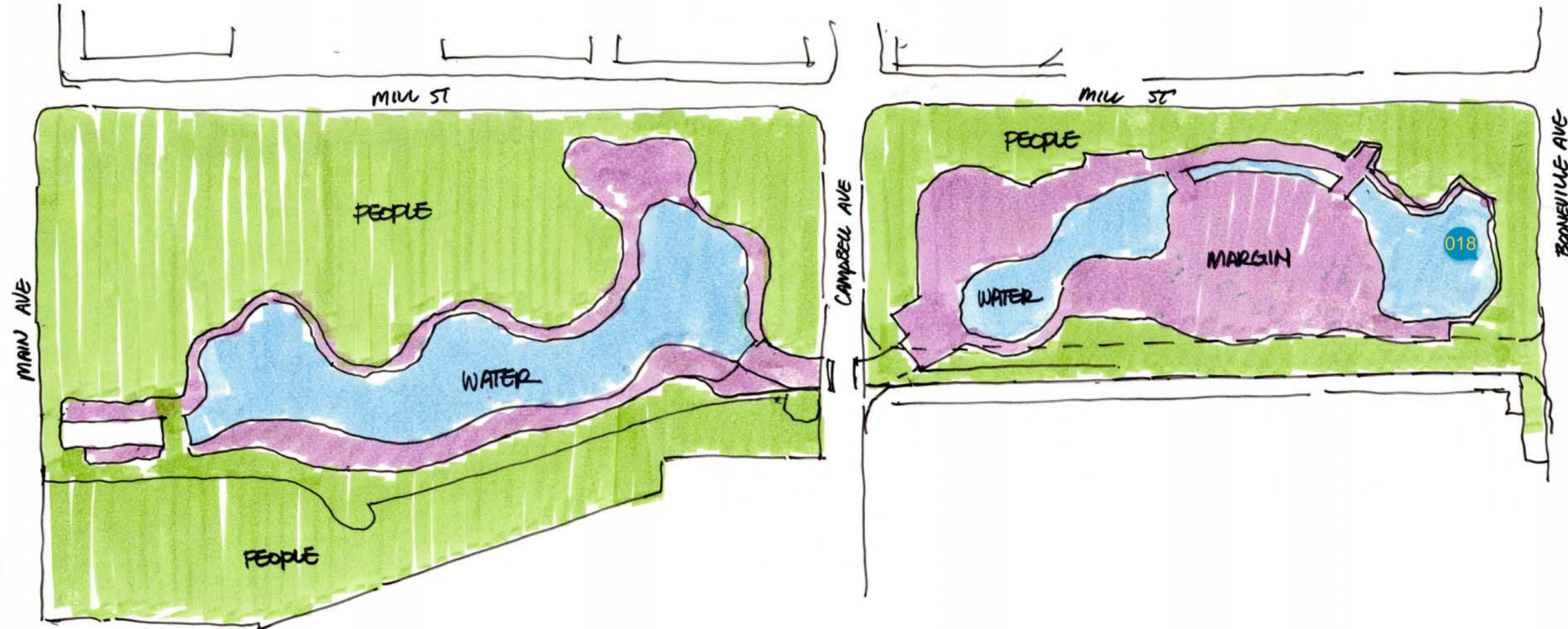

#018

Posted by **Anonymous** on **04/05/2021** at **8:18am** [Comment ID: 5430] - [Link](#)

Agree: 0, Disagree: 0

Water too wide - needs to flow



#019

Posted by **Tim Rosenbury** on **04/02/2021** at **9:48am** [Comment ID: 5353] - [Link](#)

Agree: 0, Disagree: 0

This ketch helps me to imagine this as a really nice street edge development

#020

Posted by **Tim Rosenbury** on **04/02/2021** at **9:34am** [Comment ID: 5345] - [Link](#)

Type: Idea

Agree: 0, Disagree: 0

Really like the way this responds to movement patterns within Brick City

#021

Posted by **Chris Dunnaway** on **04/02/2021** at **2:14pm** [Comment ID: 5380] - [Link](#)

Agree: 0, Disagree: 0

I like this concept of removing the box culverts and maximizing the space here and the idea for Water St. as a pedestrian promenade.

Reply by **Tim Rosenbury** on **04/02/2021** at **2:41pm** [Comment ID: 5385] - [Link](#)

Type: Idea

Agree: 1, Disagree: 0

Yes! This may be the gap-closer in the existing Greenways trails in east and west sections of JVP.

Reply by **Mary Kromrey** on **04/05/2021** at **11:04am** [Comment ID: 5442] - [Link](#)

Agree: 0, Disagree: 0

Yes-y'all may be on to something here in filling this gap in the Jordan Creek Greenway trail.

#022

Posted by **Tim Rosenbury** on **04/02/2021** at **9:38am** [Comment ID: 5347] - [Link](#)

Type: Question

Agree: 0, Disagree: 0

Is the placement of (presumably private) buildings on this public site in response to a sense that the site is too big for open space? Or what?

#023

Posted by **Chris Dunnaway** on **04/02/2021** at **2:17pm** [Comment ID: 5382] - [Link](#)

Type: Idea

Agree: 0, Disagree: 0

Regardless of which option is chosen, I believe there will need to be an additional bridge built at Campbell Ave. (north of the stone arch bridge) to meet the flood reduction goals for the project.

#024

Posted by **Chris Dunnaway** on **04/02/2021** at **2:16pm** [Comment ID: 5381] - [Link](#)

Type: Idea

Agree: 1, Disagree: 0

Preserving and restoring this stone arch bridge could really be an iconic piece for this area and would preserve some of the history.

#025

Posted by **Anonymous** on **04/05/2021** at **8:26am** [Comment ID: 5432] - [Link](#)

Agree: 0, Disagree: 0

Like the culvert gone but water too wide - will be stagnant.

#026

Posted by **Sarah Davis** on **04/05/2021** at **3:12pm** [Comment ID: 5453] - [Link](#)

Type: Idea

Agree: 0, Disagree: 0

I don't feel creating a lake is an appropriate use of Jordan Creek in this area.

#027

Posted by **Ryan Mooney** on **04/02/2021** at **4:21pm** [Comment ID: 5403] - [Link](#)

Type: Answer

Agree: 0, Disagree: 0

I like that you are incorporating development into the project. Whether it ends up this close or not, weaving a fabric of creek, stormwater basin and development is important as opposed to segmenting them all off to their own areas.

#028

Posted by **Tim Rosenbury** on **04/02/2021** at **9:33am** [Comment ID: 5344] - [Link](#)

Type: Question

Agree: 1, Disagree: 0

This parking has a GREAT VIEW of the site! Is that the best use of this part of the site?

#029

Posted by **Anonymous** on **04/05/2021** at **8:24am** [Comment ID: 5431] - [Link](#)

Agree: 0, Disagree: 0

Development taking up too much public space that is needed for all the uses/elements that the public has said they want. Too close to the creek. Multi-family is not a use for everyone. Nearby development needs to provide amenities for users (restaurants, etc.)

#030

Posted by **Ryan Mooney** on **04/02/2021** at **4:22pm** [Comment ID: 5404] - [Link](#)

Agree: 0, Disagree: 0

I get how the "lakes" could be attractive to the developments but they are not very approachable. Plus they attract trash, stale/stagnant water and geese! =)

#031

Posted by **John McQueary** on **04/02/2021** at **3:41pm** [Comment ID: 5388] - [Link](#)

Agree: 1, Disagree: 0

Development on these two sites should be minimal, except for perhaps a F&B outlet. In my opinion, the goal for this site is to create the amazing amenity. That in turn will spur the desired developments in adjacent private property. Let's not force the development within the amenity.

#032

Posted by **Tim Rosenbury** on **04/02/2021** at **9:36am** [Comment ID: 5346] - [Link](#)

Agree: 0, Disagree: 0

At first glance this feels oddly suburban. Is that what is intended?

#033

Posted by **Chris Dunnaway** on **04/02/2021** at **2:09pm** [Comment ID: 5379] - [Link](#)

Type: Idea

Agree: 1, Disagree: 0

I would prefer to not see new development in this lower area which will likely remain in the floodplain. Maybe an alternative location for this development could be immediately south of Water St. overlooking this area.

Reply by **Kirkland preston** on **04/02/2021** at **4:23pm** [Comment ID: 5405] - [Link](#)

Type: Idea

Agree: 0, Disagree: 0

Agree 100% about development in the floodplain. Seems like there are opportunities for under utilized buildings surrounding the site to redevelop w/o adding development.

West Side – Medium Development

- Mixed-use development
- Below grade or first floor parking
- Adventure play
- Art

East Side - Box Hugger

- Minimize channel directly against box edge
- Maximize site area between Mill St. and Stream
- Develop at street elevation

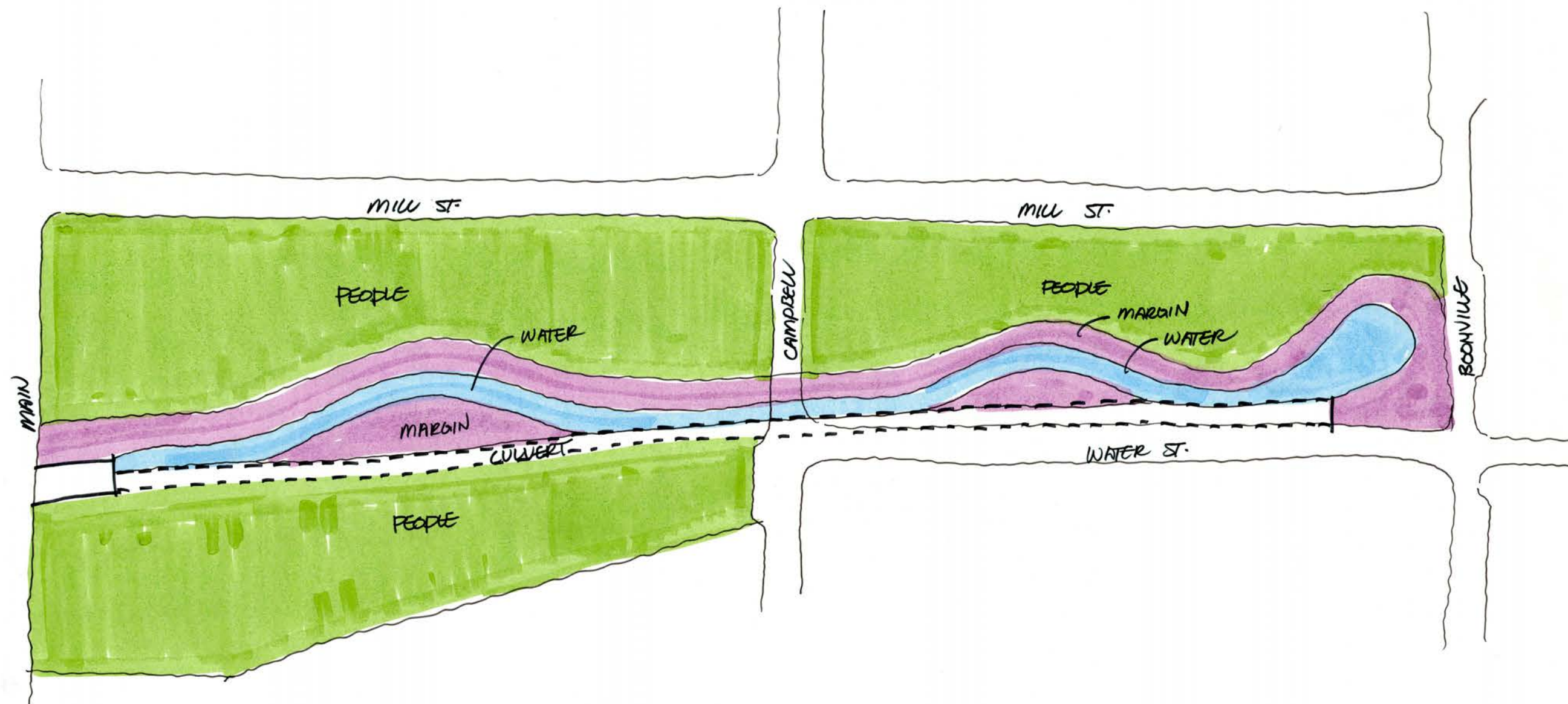

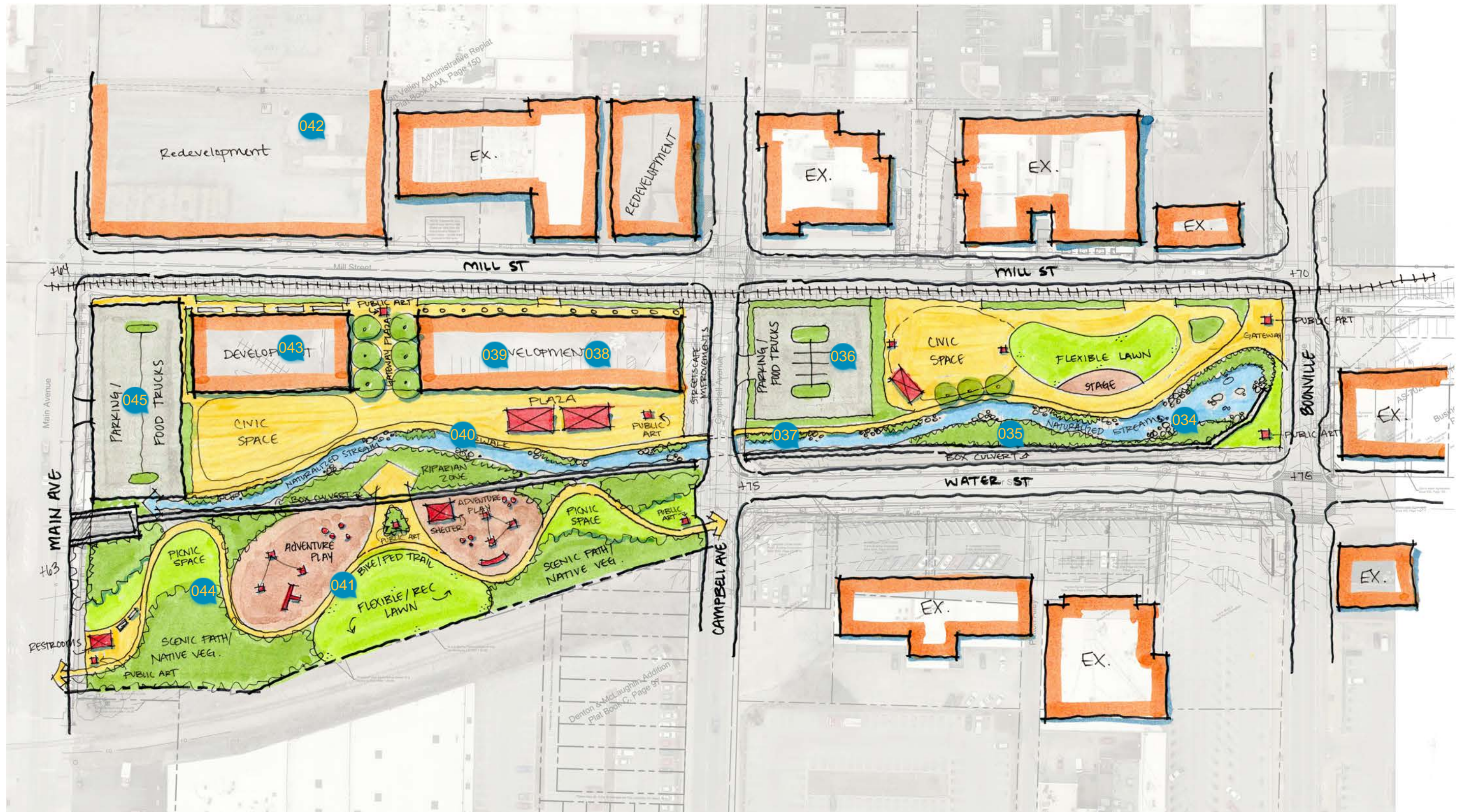

#034

Posted by **Anonymous** on **04/05/2021** at **8:30am** [Comment ID: 5434] - [Link](#)

Agree: 0, Disagree: 0

Box hugger needs to allow some plantings in between creek and wall to soften and provide riparian benefit. May be difficult to access for maintenance.

#035

Posted by **Kirkland preston** on **04/02/2021** at **4:59pm** [Comment ID: 5420] - [Link](#)

Type: Idea

Agree: 0, Disagree: 0

The more simple natural channel seems like it'd be more resilient to flooding (and post flood clean-up) than some of the other designs with pedestrian bridges and manicured plantings.

#036

Posted by **Tim Rosenbury** on **04/02/2021** at **9:40am** [Comment ID: 5348] - [Link](#)

Type: Idea

Agree: 2, Disagree: 0

I'm concerned about parking as figural space, especailly along significant streets -- feels anti-urban

#037

Posted by **Chris Dunnaway** on **04/02/2021** at **4:11pm** [Comment ID: 5401] - [Link](#)

Type: Idea

Agree: 1, Disagree: 0

The box hugger concept has little meander and the section adjacent to the box would make it feel very "urban" i.e. large concrete wall next to a creek which would take away from the desire for a more natural park like space.

#038

Posted by **Anonymous** on **04/05/2021** at **8:28am** [Comment ID: 5433] - [Link](#)

Agree: 0, Disagree: 0

Development taking up too much public space and too close to the creek.

#039

Posted by **Tim Rosenbury** on **04/02/2021** at **9:42am** [Comment ID: 5349] - [Link](#)

Type: Question

Agree: 1, Disagree: 0

I wonder if "development" would be better on the south side of this site, away from the railroad track?

Reply by **Chris Dunnaway** on **04/02/2021** at **2:21pm** [Comment ID: 5383] - [Link](#)

Type: Answer

Agree: 0, Disagree: 0

Yes. And up higher i.e. well above the floodplain. While the development itself would be elevated to meet the City's code for developing in the floodplain, it would present another obstacle in the way of floodwaters trying to move through this area.

#040

Posted by **Kirkland preston** on **04/02/2021** at **4:38pm** [Comment ID: 5418] - [Link](#)

Type: Idea

Agree: 0, Disagree: 0

I like the idea of "river walk" or "creek walk" so that people can get up close to the water and experience it and maybe even hear the gurgle of flow.

#041

Posted by **John McQueary** on **04/02/2021** at **8:20pm** [Comment ID: 5421] - [Link](#)

Agree: 0, Disagree: 0

Since we will be connecting to greenways here, let's consider a bike specific amenity. Something like a bike pump track through one or both of these sites could be very engaging, and would take little maintenance, not much extra space and no staffing.

#042

Posted by **Sarah Davis** on **04/05/2021** at **3:13pm** [Comment ID: 5454] - [Link](#)

Type: Idea

Agree: 0, Disagree: 0

Second favorite design - more tidy and manicured version of Idea 3. Very park like.

#043

Posted by **Sarah Davis** on **04/05/2021** at **3:04pm** [Comment ID: 5447] - [Link](#)

Type: Idea

Agree: 0, Disagree: 0

I don't believe this is the appropriate area for new parking lots and large development.

#044

Posted by **Chris Dunnaway** on **04/02/2021** at **2:24pm** [Comment ID: 5384] - [Link](#)

Type: Idea

Agree: 0, Disagree: 0

I like all of the greenspace and trail through this area.

#045

Posted by **John McQueary** on **04/02/2021** at **3:46pm** [Comment ID: 5390] - [Link](#)

Agree: 3, Disagree: 0

I don't like the idea of two parking lots within the amenity. You lose a lot of real estate to just the circulation part of this type of parking. I feel the single row of parking along the North edge is most efficient and disturbs the concept the least.

Reply by **Branden Schwab** on **04/02/2021** at **10:10pm** [Comment ID: 5423] - [Link](#)

Agree: 0, Disagree: 0

Agree, would like to see angled parking along edges rather than lots.

IDEA THREE

West Side – Small Development

- Adventure play
- Flexible sports
- Meadows / natives
- Shelters / restrooms
- Art

East Side - Middle Meander

- Minimize channel and margin area
- Develop closer to street elevation
- Develop both sides of stream

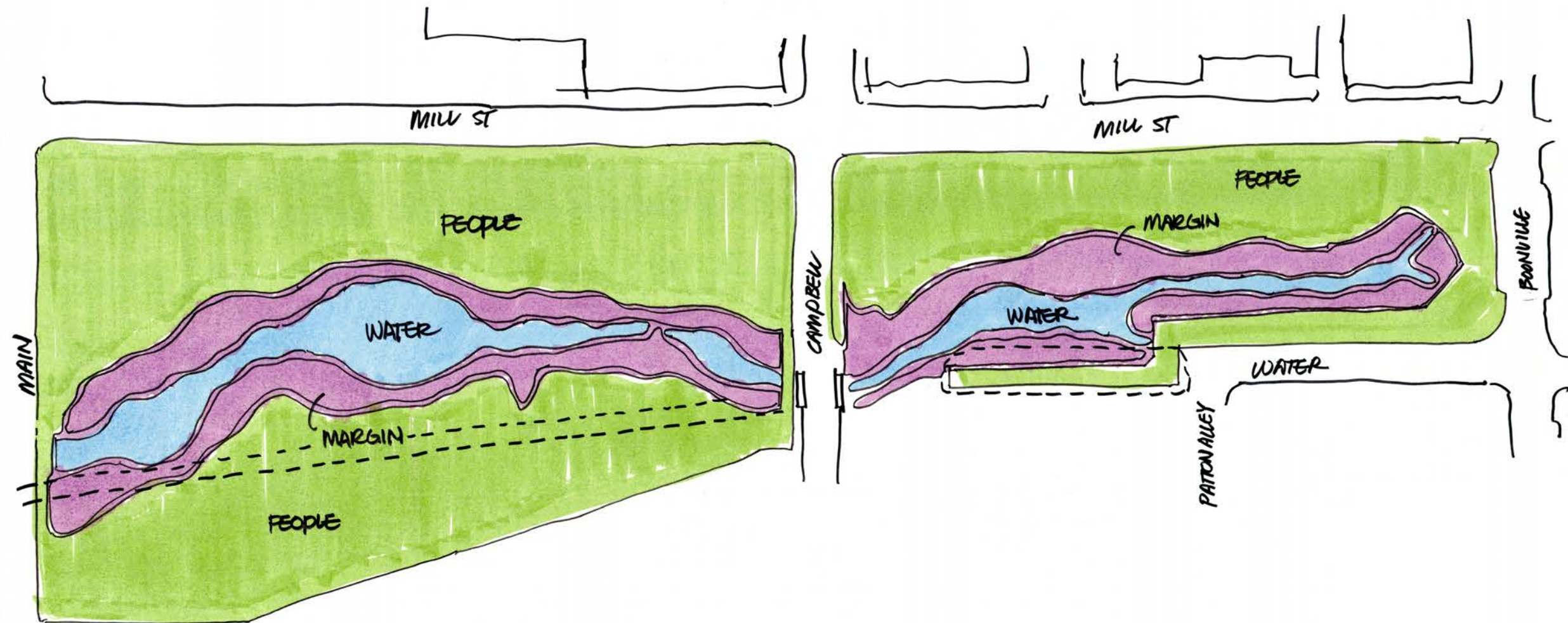

#046

Posted by **Mary Kromrey** on **04/05/2021** at **11:08am** [Comment ID: 5445] - [Link](#)

Type: Question

Agree: 0, Disagree: 0

How will the Jordan Creek Greenway trail travel thru/by this space and then continue east to connect to the trail that begins at Jefferson Avenue?

#047

Posted by **John McQueary** on **04/02/2021** at **4:02pm** [Comment ID: 5399] - [Link](#)

Agree: 1, Disagree: 0

I like this word "icon", or "iconic". This is so key in my opinion. We need to designate at least one space for a singular iconic art piece.

#048

Posted by **Tim Rosenbury** on **04/02/2021** at **9:44am** [Comment ID: 5350] - [Link](#)

Type: Question

Agree: 0, Disagree: 0

Does locating a building here in the east-west direction improve access from Brick City, or does it hinder it?

#049

Posted by **John McQueary** on **04/02/2021** at **3:43pm** [Comment ID: 5389] - [Link](#)

Agree: 0, Disagree: 0

Love the multiple bridges concept. The bridges should be unique and attractive within themselves, and not "bare minimum".

#050

Posted by **Chris Dunnaway** on **04/02/2021** at **3:59pm** [Comment ID: 5398] - [Link](#)

Type: Idea

Agree: 0, Disagree: 0

We would need to visit with the Traffic Dept. and the public, but I think this concept with Water St. has merit.

#051

Posted by **Ryan Mooney** on **04/02/2021** at **4:24pm** [Comment ID: 5407] - [Link](#)

Agree: 0, Disagree: 0

All the bridges are very cool! Lots of connectivity across the water makes it feel more accessible.

#052

Posted by **Ryan Mooney** on **04/02/2021** at **4:28pm** [Comment ID: 5412] - [Link](#)

Agree: 0, Disagree: 0

I like having restaurant/cafe space in the park. We'll have to have that to help create additional experiences and hopefully be a venue to serve alcohol!

#053

Posted by **Tim Rosenbury** on **04/02/2021** at **9:45am** [Comment ID: 5351] - [Link](#)

Type: Idea

Agree: 1, Disagree: 0

Bridges a multiple levels is a cool concept

Reply by **Branden Schwab** on **04/02/2021** at **1:10pm** [Comment ID: 5368] - [Link](#)

Agree: 0, Disagree: 0

Agree! See also how Antoine Predock's McNamara Alumni Center at Univ. of Minnesota connects to adjacent buildings, similar to alabaster clad bridges at Canadian Museum for Human Rights

#054

Posted by **Anonymous** on **04/05/2021** at **8:34am** [Comment ID: 5436] - [Link](#)

Agree: 0, Disagree: 0

Like removal of box starting here.

#055

Posted by **Sarah Davis** on **04/05/2021** at **3:08pm** [Comment ID: 5450] - [Link](#)

Type: Idea

Agree: 0, Disagree: 0

Like that there could be some elevated viewing of the project from closed Water St.

#056

Posted by **Branden Schwab** on **04/02/2021** at **10:20pm** [Comment ID: 5425] - [Link](#)

Type: Question

Agree: 0, Disagree: 0

whether its a grate or a boardwalk w/ open railing, how minimal could railings be? At what depth of water or drop off from path is a handrail required?

#057

Posted by **Branden Schwab** on **04/02/2021** at **10:43pm** [Comment ID: 5427] - [Link](#)

Type: Idea

Agree: 0, Disagree: 0

Consider participating in Equal Justice Initiative (EJI) Community Remembrance Project in civic spaces? The Historical Marker project could respectfully recognize the lynching of Horace Duncan, Fred Coker and William Allen in 1906. <https://www.instagram.com/p/B4lZxCvnjS1ub6fSJ7K0uOgoj70l2i6QkGvAmE0/>

<https://museumandmemorial.eji.org/news/eji-community-remembrance-project>

#058

Posted by **Branden Schwab** on **04/02/2021** at **1:18pm** [Comment ID: 5372] - [Link](#)

Agree: 0, Disagree: 0

How does this corner engage Melton Elec. Bldg as an art hub?

#059

Posted by **Branden Schwab** on **04/02/2021** at **1:17pm** [Comment ID: 5371] - [Link](#)

Agree: 0, Disagree: 0

Melton Electric bldg, art hub

#060

Posted by **Sarah Davis** on **04/05/2021** at **3:07pm** [Comment ID: 5449] - [Link](#)

Type: Idea

Agree: 0, Disagree: 0

Yay, love keeping the historic Campbell bridge!

#061

Posted by **Ryan Mooney** on **04/02/2021** at **4:24pm** [Comment ID: 5406] - [Link](#)

Agree: 1, Disagree: 0

I like how this plan uses the corners as civic plazas or as icons with public art, etc. These make the whole project feel more like a signature piece.

#062

Posted by **Ryan Mooney** on **04/02/2021** at **4:25pm** [Comment ID: 5408] - [Link](#)

Agree: 1, Disagree: 0

The pool/cascade (ok, maybe not cascade...ripple) works well in this layout. I think it might be the best way to get the creek to show off visually and be approachable.

#063

Posted by **Ryan Mooney** on **04/02/2021** at **4:26pm** [Comment ID: 5409] - [Link](#)

Agree: 0, Disagree: 0

Water Street doesn't have much connection value so removing it is a great way to use more land along the creek and use more of the topography.

Reply by **Mary Kromrey** on **04/05/2021** at **11:07am** [Comment ID: 5444] - [Link](#)

Type: Question

Agree: 0, Disagree: 0

Or would this be a way to fill a gap in the Jordan Creek Greenway trail?

#064

Posted by **Branden Schwab** on **04/02/2021** at **10:17pm** [Comment ID: 5424] - [Link](#)

Agree: 0, Disagree: 0

yes!! angled parking along street edge makes the most sense here. Consider how west moving traffic could still swing into these spaces, rather than spaces only being accessed from east-bound lane. Consider relaxing angle to find a sweet spot that works well for both directions of travel.

#065

Posted by **Branden Schwab** on **04/02/2021** at **1:26pm** [Comment ID: 5377] - [Link](#)

Agree: 0, Disagree: 0

this water & margin space seems out of scale... to wide north to south?

Reply by **Branden Schwab** on **04/02/2021** at **1:26pm** [Comment ID: 5378] - [Link](#)

Agree: 0, Disagree: 0

*too

#066

Posted by **Anonymous** on **04/05/2021** at **8:34am** [Comment ID: 5435] - [Link](#)

Agree: 0, Disagree: 0

Great use of space to remove Water and the prairie provides a nice element to contrast with others.

#067

Posted by **Tim Rosenbury** on **04/02/2021** at **9:47am** [Comment ID: 5352] - [Link](#)

Type: Idea

Agree: 1, Disagree: 0

I realize it's mostly the drawing technique, but this suggests to me that the water is doing lots of different things, in this plan. It's reassuring to see this

Reply by **Chris Dunnaway** on **04/02/2021** at **2:44pm** [Comment ID: 5386] - [Link](#)

Type: Idea

Agree: 1, Disagree: 0

Yes. I imagine, this includes a variety of pools, riffles, drop structures, etc. just like what we see in many of the local streams. This would allow for different experiences of the water too (some places slow moving water other places fast moving water).

#068

Posted by **John McQueary** on **04/02/2021** at **3:48pm** [Comment ID: 5392] - [Link](#)

Agree: 2, Disagree: 0

Love the idea of exposing and embracing the boulders and other natural features like this.

Reply by **Ryan Mooney** on **04/02/2021** at **4:27pm** [Comment ID: 5410] - [Link](#)

Agree: 0, Disagree: 0

Agreed!

Reply by **Kirkland preston** on **04/02/2021** at **4:28pm** [Comment ID: 5411] - [Link](#)

Type: Idea

Agree: 0, Disagree: 0

Me too. Exposing existing boulders seems like a real good way to celebrate the Ozarks - and showcase the native limestone.

#069

Posted by **Mary Kromrey** on **04/05/2021** at **11:06am** [Comment ID: 5443] - [Link](#)

Agree: 0, Disagree: 0

A trailhead is planned at the rear of the current BRP parking lot. Also a trailhead at the west end of the trail in West Meadows-not convinced that this is the best space for a trailhead.

#070

Posted by **Chris Dunnaway** on **04/02/2021** at **3:00pm** [Comment ID: 5387] - [Link](#)

Type: Idea

Agree: 0, Disagree: 0

Love the prairie concept. Sort of be an extension of West Meadows.

#071

Posted by **Sarah Davis** on **04/05/2021** at **3:07pm** [Comment ID: 5448] - [Link](#)

Type: Idea

Agree: 0, Disagree: 0

This is my favorite of the proposed designs. There's a realistic creek design, lots of open space, and opportunities for outdoor activities.

#072

Posted by **Branden Schwab** on **04/02/2021** at **1:14pm** [Comment ID: 5369] - [Link](#)

Type: Question

Agree: 0, Disagree: 0

Headline Productions located here. Steward of downtown culture & backstage masters for Gillioz. Does redevelopment push them out?

Reply by **Branden Schwab** on **04/02/2021** at **1:17pm** [Comment ID: 5370] - [Link](#)

Agree: 0, Disagree: 0

nvrmind, Headline is further north at NE corner of Phelps & Main

IDEA FOUR

West Side – Small Development

- Adventure play
- Flexible sports
- Meadows / natives
- Shelters / restrooms
- Art

East Side - Middle Meander

- Minimize channel and margin area
- Develop closer to street elevation
- Develop both sides of stream

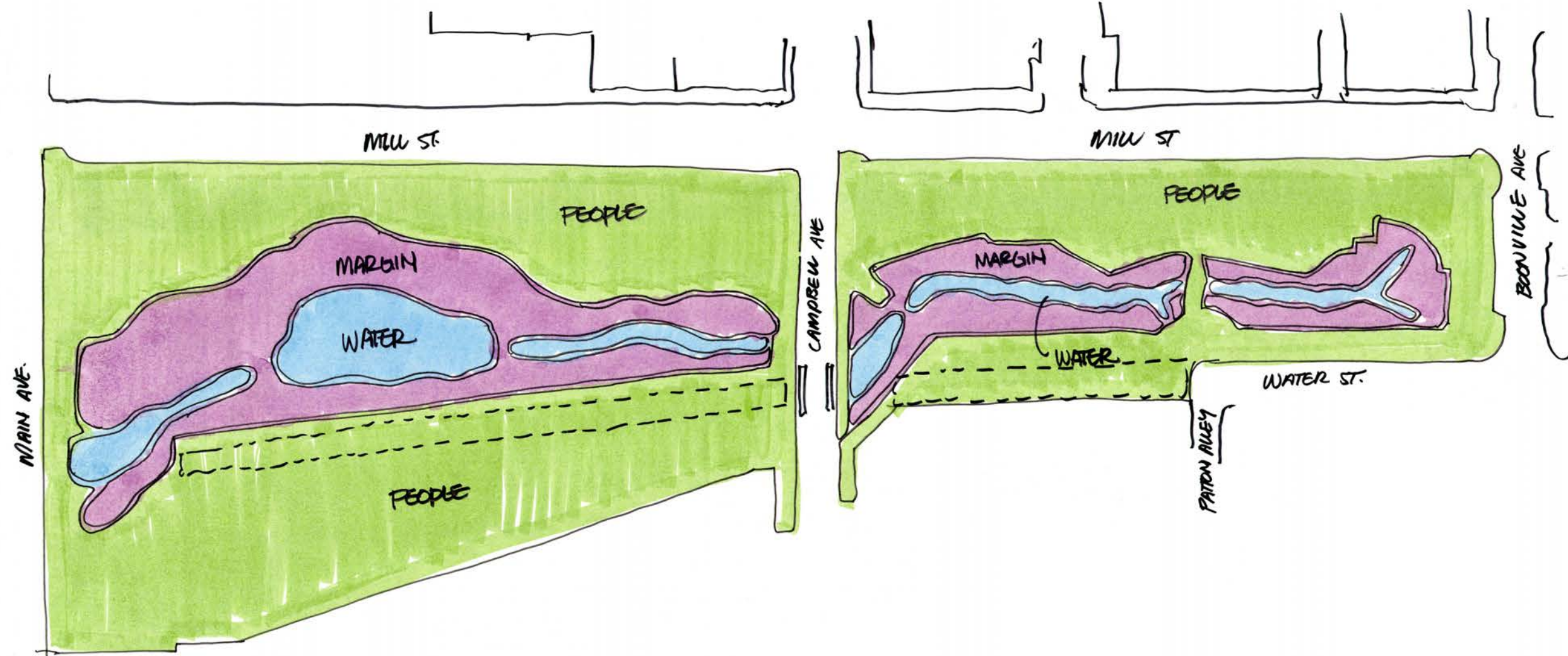

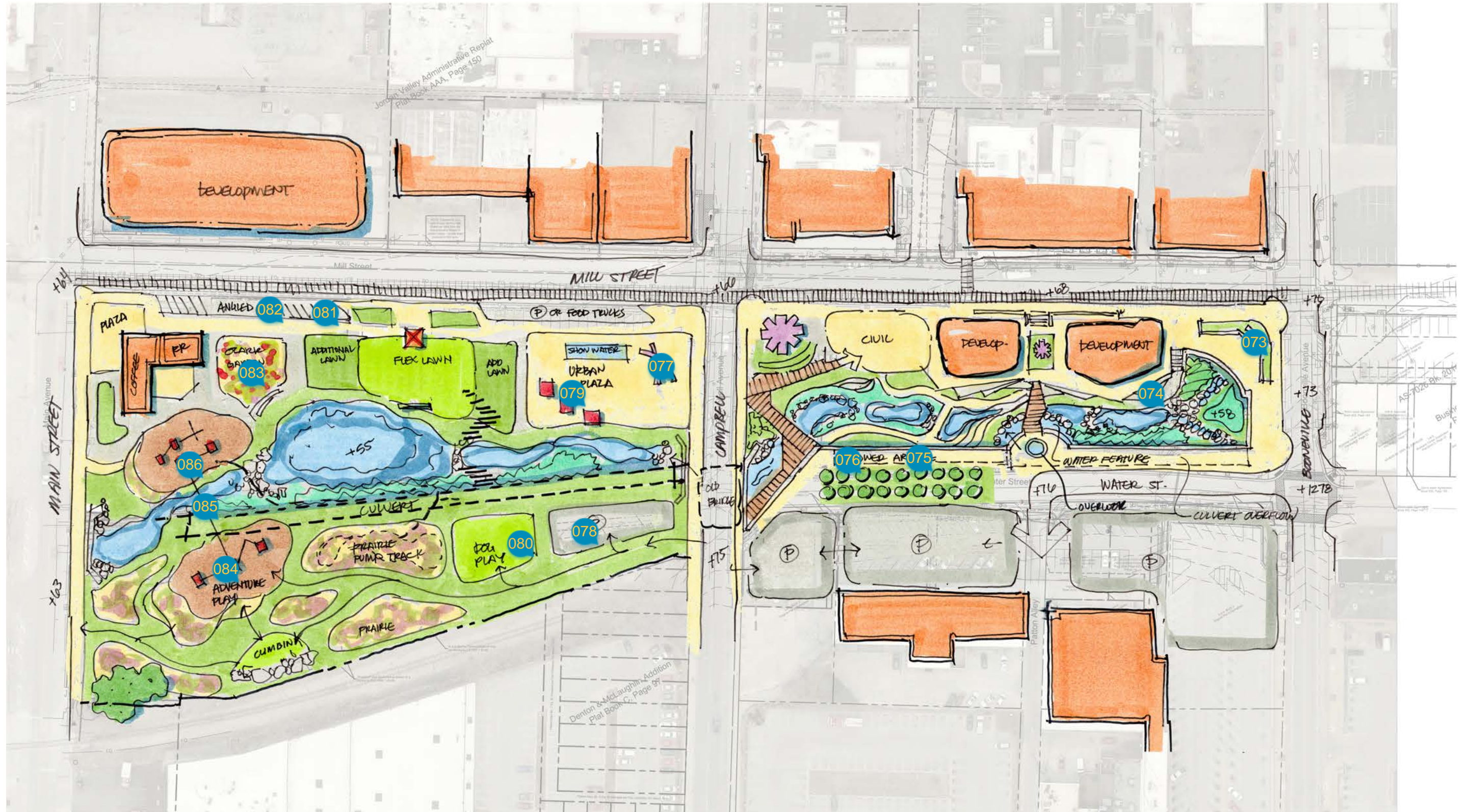

#073

Posted by **Branden Schwab** on **04/02/2021** at **1:24pm** [Comment ID: 5374] - [Link](#)

Agree: 0, Disagree: 0

here's the grand stair! Great approach, consider how this can bottle next at the top and widen as it descends, transitioning from a pedestrian space (wide sidewalk, min 7' with center railing) to a space for sitting/gathering at the base.

Reply by **Branden Schwab** on **04/02/2021** at **1:24pm** [Comment ID: 5375] - [Link](#)

Agree: 0, Disagree: 0

bottleneck*

#074

Posted by **Branden Schwab** on **04/02/2021** at **1:21pm** [Comment ID: 5373] - [Link](#)

Type: Idea

Agree: 0, Disagree: 0

Nod to FW Fountain/Phillip Johnson's Alice in Wonderland/Thru the Looking Glass? Boone has already acknowledged danger of 9' pool, but the origami folding terraces idea is strong... especially as it orients towards views of setting sun to the west or encourages sunbathing. Consider orienting more towards W/SW as grand public stair/stramp concept?

#075

Posted by **John McQueary** on **04/02/2021** at **3:59pm** [Comment ID: 5397] - [Link](#)

Agree: 2, Disagree: 0

The arcade here is a crazy idea, and I like crazy ideas. I think we should continue to flush this out a bit and see where it takes us. It's worth exploring even if it doesn't end up being feasible.

#076

Posted by **Kirkland preston** on **04/02/2021** at **4:49pm** [Comment ID: 5419] - [Link](#)

Type: Question

Agree: 0, Disagree: 0

What would this area look like? Is it like an open side/covered area that used to be the box culvert? If so, the existing box culvert structure isn't too visually appealing.

#077

Posted by **Ryan Mooney** on **04/02/2021** at **4:31pm** [Comment ID: 5414] - [Link](#)

Agree: 0, Disagree: 0

This concept of an attractive urban plaza at the corner is a good one. It provides flexible space for different uses but also makes the whole area more inviting from the street level.

#078

Posted by **Sarah Davis** on **04/05/2021** at **3:03pm** [Comment ID: 5446] - [Link](#)

Type: Idea

Agree: 0, Disagree: 0

I would say that this is not the area for new parking lots.

#079

Posted by **Branden Schwab** on **04/02/2021** at **10:46pm** [Comment ID: 5428] - [Link](#)

Agree: 0, Disagree: 0

perhaps these three monuments are appropriate locations for the EJI's weatherd steel "coffins", commemorating 1906 lynchings:
<https://museumandmemorial.eji.org/news/eji-community-remembrance-project>

#080

Posted by **Kirkland preston** on **04/02/2021** at **4:33pm** [Comment ID: 5416] - [Link](#)

Type: Idea

Agree: 1, Disagree: 0

I know sometimes dog parks/dogs can be a water quality concern, but there's probably a good solution/management technique for dog waste to make it workable.

#081

Posted by **Sarah Davis** on **04/05/2021** at **3:09pm** [Comment ID: 5451] - [Link](#)

Type: Idea

Agree: 0, Disagree: 0

I agree that angled parking could be a nice approach to avoid adding large parking lots.

#082

Posted by **John McQueary** on **04/02/2021** at **3:47pm** [Comment ID: 5391] - [Link](#)

Agree: 2, Disagree: 0

I feel this style of parking is most efficient on these sites.

#083

Posted by **Kirkland preston** on **04/02/2021** at **4:35pm** [Comment ID: 5417] - [Link](#)

Type: Idea

Agree: 0, Disagree: 0

Love the Ozark garden.

#084

Posted by **John McQueary** on **04/02/2021** at **3:55pm** [Comment ID: 5396] - [Link](#)

Agree: 0, Disagree: 0

I love adventure play as a concept. We just can't build something that needs staffed.

#085

Posted by **Branden Schwab** on **04/02/2021** at **1:25pm** [Comment ID: 5376] - [Link](#)

Agree: 0, Disagree: 0

cool!

#086

Posted by **Ryan Mooney** on **04/02/2021** at **4:29pm** [Comment ID: 5413] - [Link](#)

Agree: 2, Disagree: 0

I love the "adventure play" idea. This feels like more of what exists in The Gathering Place. I know we can't replicate the scale of that development but those interactive play areas are what help make the park.

IDEA FIVE

West Side - Big Development

- Mixed-use development
- Below grade or first floor parking
- Remove box culvert
- Native trails / meadows

East Side - Big Scoop

- Broad big excavation
- Creates most stormwater storage
- People space / use below street level

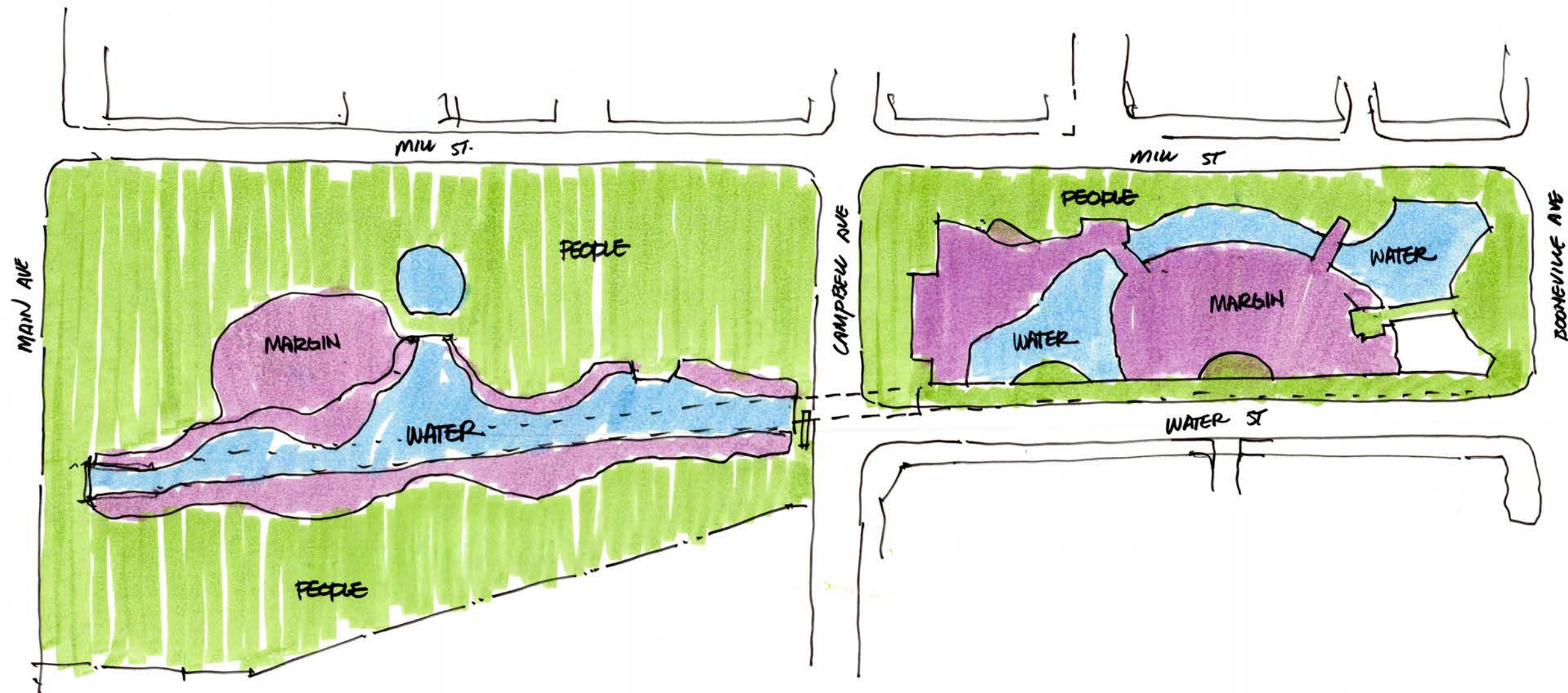

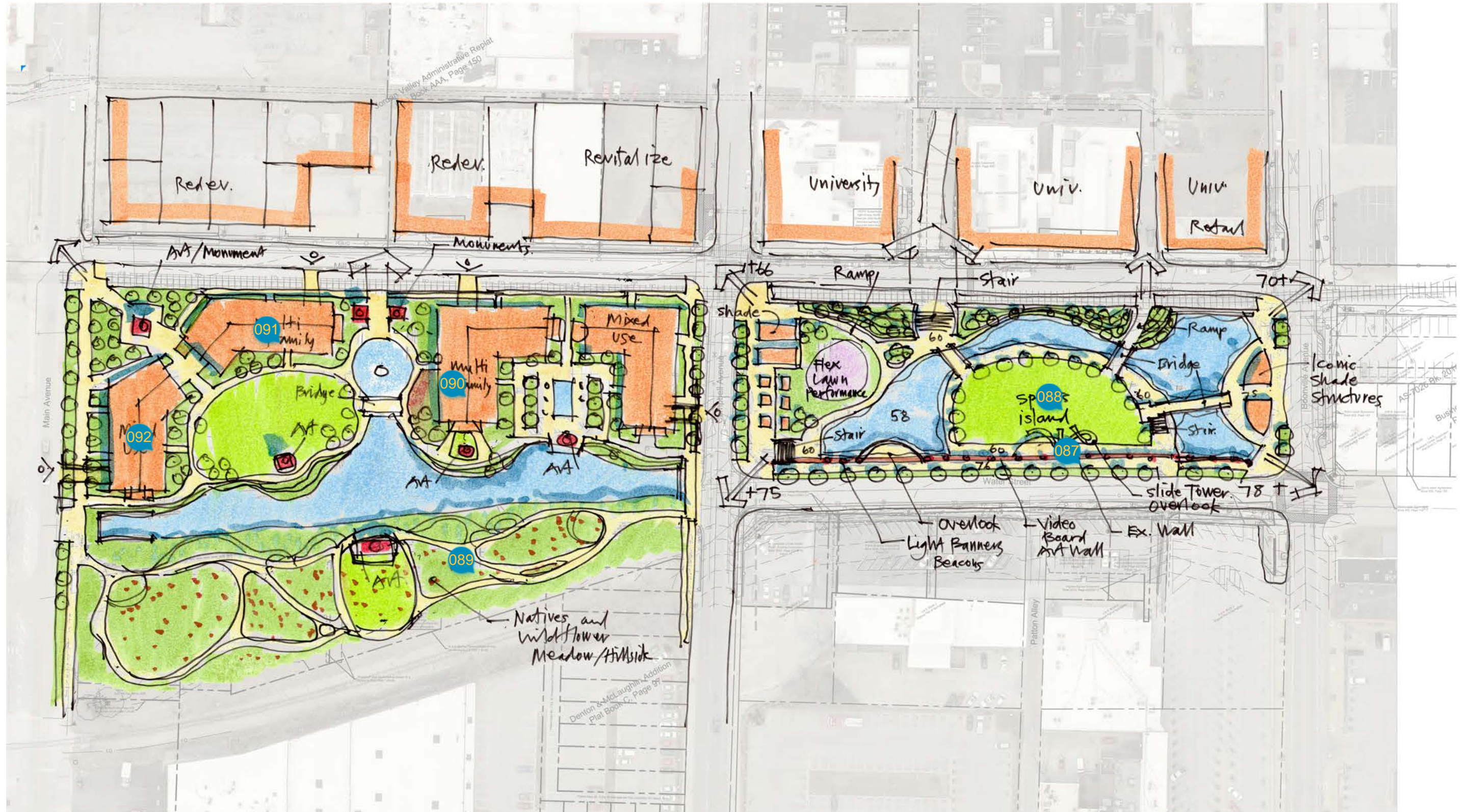

#087

Posted by **Ryan Mooney** on **04/02/2021** at **4:32pm** [Comment ID: 5415] - [Link](#)

Agree: 0, Disagree: 0

Love the slide! Sound like we are trying to incorporate FUN! (This was a major theme of Peter Kageyama's message.)

Reply by **Branden Schwab** on **04/02/2021** at **10:34pm** [Comment ID: 5426] - [Link](#)

Agree: 0, Disagree: 0

Agree with fun/play as a priority, especially when it goes beyond typical playground equipment pulled from a catalog. See Helen & Hard's use of big brightly colored, densely packed inflated spheres in Norway: https://www.archdaily.com/635551/geopark-helen-and-hard?ad_medium=office_landing&ad_name=article or Snarkitecture in Hong Kong... consider how elements could continue into the water? <https://www.archdaily.com/900129/snarkitectures-bounce-offers-a-surreal-playground-to-hong-kongs-waterfront>

#088

Posted by **John McQueary** on **04/02/2021** at **3:52pm** [Comment ID: 5394] - [Link](#)

Agree: 0, Disagree: 0

I like this idea of an "island" as a feature, but not sure if sports activities is the best way to engage the space.

#089

Posted by **Anonymous** on **04/05/2021** at **8:38am** [Comment ID: 5438] - [Link](#)

Agree: 0, Disagree: 0

Like the meadow with paths for nature walks.

#090

Posted by **John McQueary** on **04/02/2021** at **3:54pm** [Comment ID: 5395] - [Link](#)

Agree: 1, Disagree: 0

I feel this is too much housing development in this small space, and it doesn't feel natural anymore. I would feel like I'm hanging out in an amenity that is intended only for those that lived here.

#091

Posted by **Anonymous** on **04/05/2021** at **8:38am** [Comment ID: 5437] - [Link](#)

Agree: 0, Disagree: 0

Too much development and multi-family not a good use of public space. This is a space for all - not tenants.

#092

Posted by **Sarah Davis** on **04/05/2021** at **3:11pm** [Comment ID: 5452] - [Link](#)

Type: Idea

Agree: 0, Disagree: 0

Way too much development.

East Side - Box Hugger

- Minimize channel directly against box edge
- Maximize site area between Mill and Stream
- Develop at street elevation

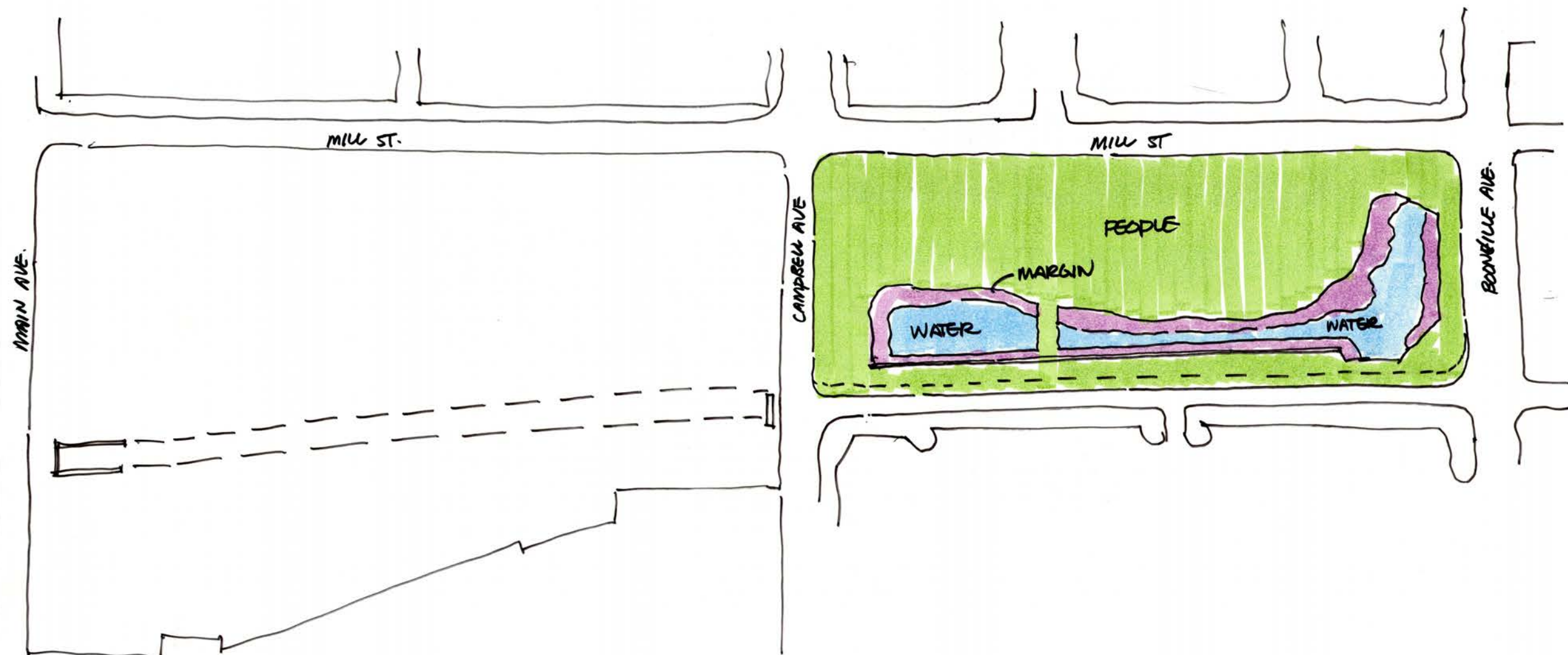



#093

Posted by **Tim Rosenbury** on **04/02/2021** at **9:56am** [Comment ID: 5354] - [Link](#)

Type: Question

Agree: 0, Disagree: 0

Of all these ideas, and when you consider the other parks and open spaces downtown, what are the ideal, best programmed activities for these schemes?

#094

Posted by **Chris Dunnaway** on **04/02/2021** at **4:04pm** [Comment ID: 5400] - [Link](#)

Type: Idea

Agree: 0, Disagree: 0

Too me this one looks a little too much like a canal where we would be attempting to squeeze the water into a narrow deep corridor.